

Series 8, Washing machine, front loader, 9 kg, RPM 1600 WGB24609AU

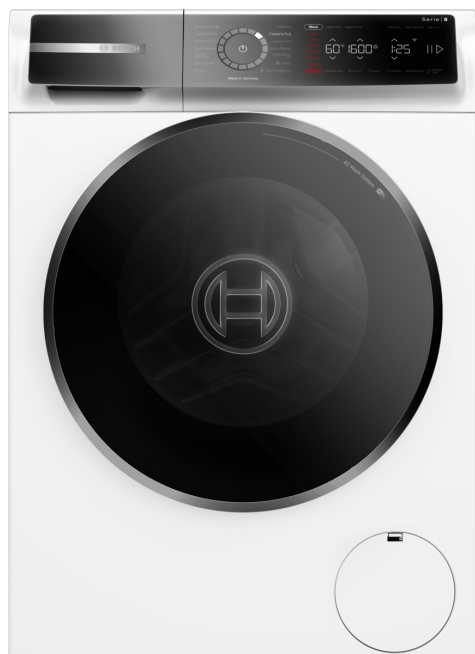

An advanced washing machine with ActiveWater Plus which saves up to 50% water and reduces your ironing pile with Iron Assist.

- **Hygiene Plus:** Hygienic washing, killing germs effectively even at 40°C ²
- **Iron Assist:** Reduce wrinkles up to 50%. ³
- **AntiStain :** Reliably removes 16 different stubborn stains without any additional pre-treatment.
- **SuperQuick 15/30:** Is a quick way of freshening up lightly-soiled laundry.
- **4D Wash System:** Highly efficient water and detergent penetration for spotless results.

Maximum capacity in kg (EU 2017/1369): 9.0 kg
 Built-in / Free-standing: Free-standing
 Dimensions of the product: 845x598x590 mm
 Net weight: 82.6 kg
 Connection rating: 2300 W
 Fuse protection: 10 A
 Voltage: 220-240 V
 Frequency: 50 Hz
 Length electrical supply cord: 160 cm
 Door hinge: Left
 Wheels: No
 EAN code: 4242005473151
 Installation type: Free-standing



WMZ2200 Floor securing component
 WMZ2381 Extension for cold water inlet /Aquastop
 WMZPW40W Platform with pull-out, washer, cubic

¹ Please refer to the Energy Star Rating or for more information, refer to www.energystar.gov.au
² Bosch washing machines with the 'AllergyPlus' wash program at 40° and 60° fulfill scientifically recommended conditions for 99,99% of germ reduction for Enterococcus Hirae and Pseudomonas Aeruginosa, according to Honisch et al. 2014, "Impact of wash cycle time, temperature and detergent formulation on the hygiene effectiveness of domestic laundering." Conducted by University Rhine-Waal
³ Test No. E-0323-PT-22 of the Deutschen Institute für Textil- und Faserforschung Denkendorf (DITF) of 12.07.22, related to the crease reduction of commercial cotton garments (T-shirts and shirts) in the Iron Assist program according to DIN EN ISO 15487 in comparison to textiles not treated with Iron Assist.

Series 8, Washing machine, front loader, 9 kg, RPM 1600 WGB24609AU

An advanced washing machine with ActiveWater Plus which saves up to 50% water and reduces your ironing pile with Iron Assist.

Capacity

- Capacity: 9 kg

Consumption rates

- 5 Star Energy Rating
- Energy consumption 225 kWh kWh per year, based on Cottons Eco 60°C program at 1600 RPM seven times per week. When tested in accordance with AS/NZS 2040.2. Actual energy use and running costs will depend on how you use the appliance.
- Water consumption 65 l litres per wash, using the Cottons Eco 60°C program at 1600 RPM. In accordance with AS/NZS 6400. Actual water consumption will depend on how the appliance is used. C02319

Programs

- Standard programs: Cottons Eco, Cottons Program cold to 90°C, Easy Care, App, Iron Assist - with added steam for wrinkle reduction, Hygiene Plus, Jeans/dark laundry, Spin / Drain, Quick wash/Mixture, Sportswear, Rinse, Super 15 min / Super 30 min, Delicates/Silk cold to 40°C, delicates/silk, Wool Hand wash cold to 40°C
- TouchControl buttons: AntiStain: Selection options of Grass, Red Wine, Oil/Butter and Blood, Temperature selection, Spin speed selection, Prewash, Finish in (delayed start): delay the start of the program by up to 24 hours, SpeedPerfect, start/pause with reload function
- Iron Assist: Steam programme that reduces wrinkles on dry clothes
- Stain automatic - 6 stains at the touch of a button, 10 further stains via Home Connect
- Special programs: Super 15 min / Super 30 min, Sportswear, Spin / Drain.
- programmes via app: Down, Drum clean with reminder, Curtains, Towels, Shirts, Outdoor

Features

- Home Connect: Smart Start, Remote Monitoring and Control, Remote Diagnostics, Onboarding, further programmes via download. Always keep your appliance up to date via firmware update.
- ActiveWater Plus: for highly efficient use of water even with small loads thanks to automatic load detection.
- Mini Load: Wash single items and small loads efficiently
- Reload function: Be flexible in adding laundry items even after start of the wash cycle.
- 4D Wash System: high efficient water and detergent distribution for spotless results.
- Hygiene Plus: clean laundry and killing germs effectively
- Drum volume: 68 l
- VarioDrum's breakthrough wave-droplet design provides a thorough yet gentle clean for fine textiles
- Large 32 cm porthole, black-chrome, black grey with 182° opening door

- EcoSilence drive for faster, quieter and more energy efficient performance
- AntiVibration Side Panels reduce vibrations and ensure greater stability during the washing and spinning process
- Sound insulation by additional damping material
- Aqua Protection Plus anti-flood protection with self-sealing hose, minimises the risk of flooding
- Foam detection to remove excessive foam
- Overdosage indication
- Unbalanced load detection
- Audible notification at the end of the programme
- Self cleaning detergent drawer to remove detergent residue
- Self-cleaning detergent drawer
- Consumption Indication: Information about energy consumption

Performance

- Spin speed: 400 - 1600 rpm

Technical Information

- Slide-under height of 85cm
- Dimensions (H x W x D): 84.5 cm x 59.8 cm x 59.0 cm (64.8 cm including door handle)
- Operating noise level for spinning at standard 60°C cotton program at full loading in dB (A): 75

Design

- Elegant and ergonomically inclined control panel for easy use
- Child safety control lock
- Water consumption 65 l litres per wash. Using the Cottons Eco program at 60°C with 1600 RPM spin speed. In accordance with AS/NZS 6400. Actual water consumption will depend on how the appliance is used. C02319.
- 5 Star Water rating (WELS)
- Includes Drain kit
- Pause/Reload function to pause the washing operation for adding in laundry items
- Sound insulation by bottom cover

**Series 8, Washing machine, front
loader, 9 kg, RPM 1600
WGB24609AU**

Measurements in mm

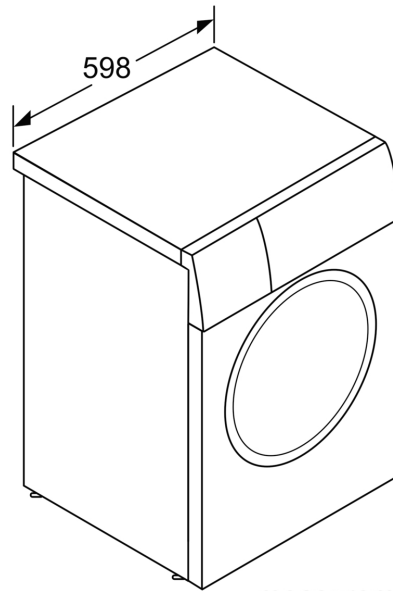
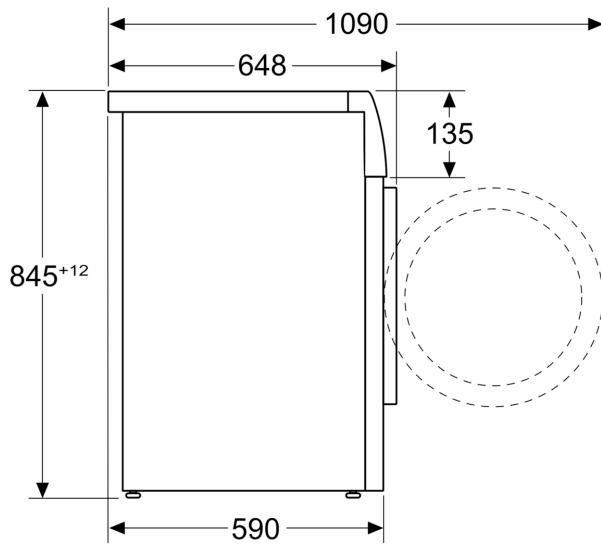

measurements in mm